

Bitvision Quick Guide



Download QR code for iOS:



Download QR code for Android:

Download link for android: http://www.bitdog.com/some_file/Bitvision.apk

After download APP on your phone please open the app and follow the picture step by step

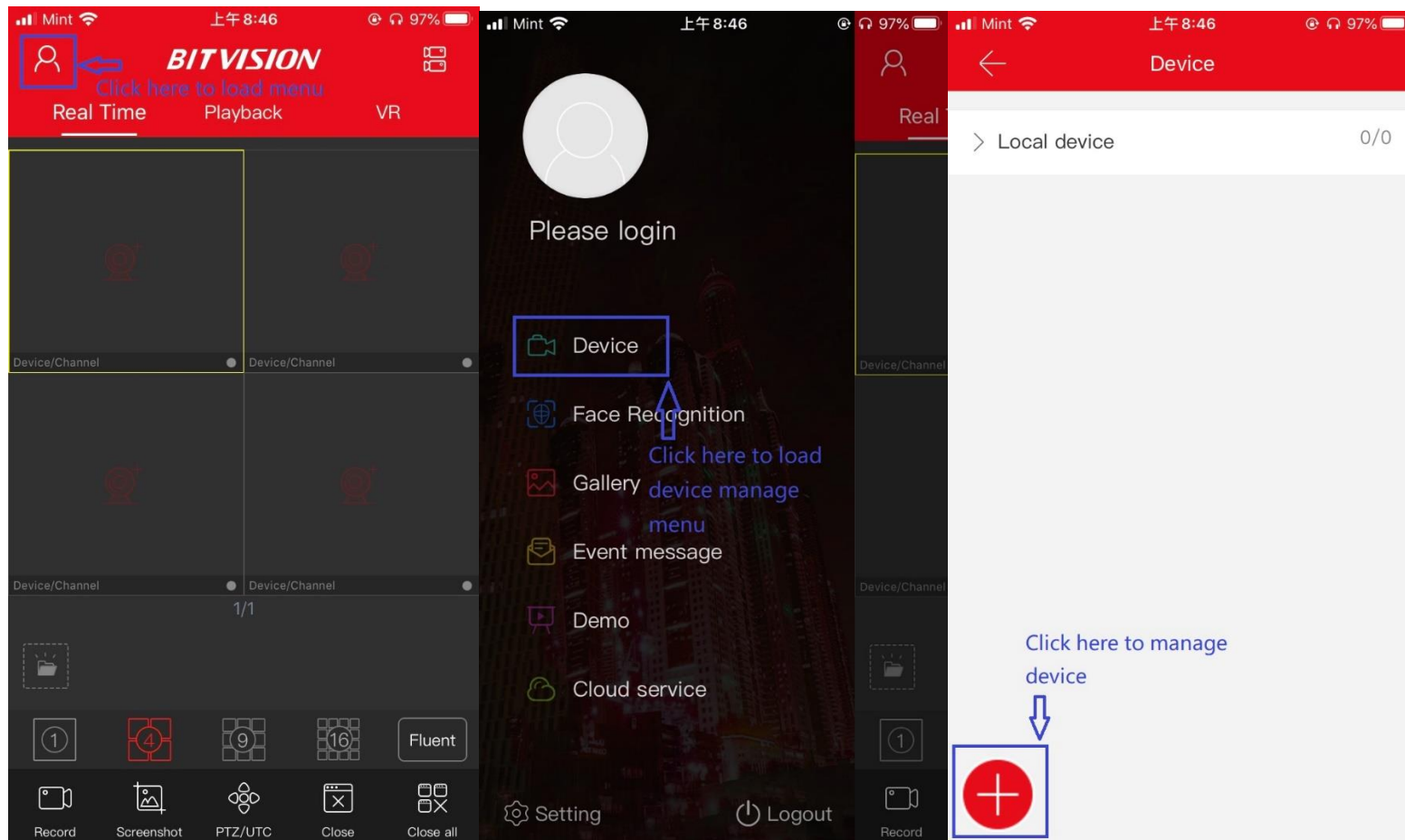

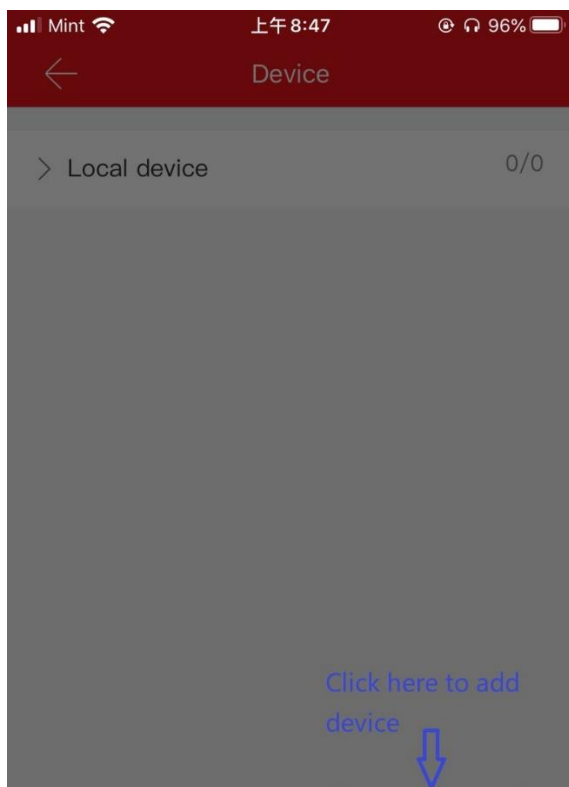

Edit

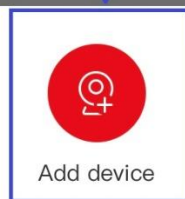

Add device

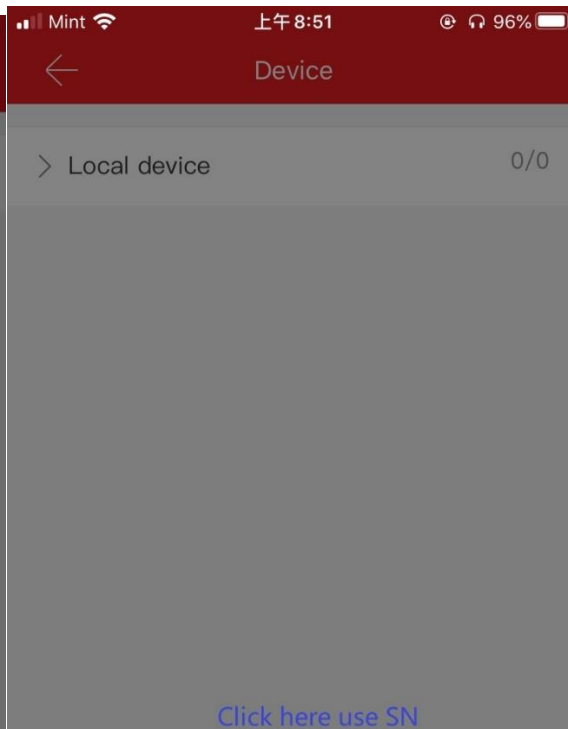

Add device

(📍) LAN search

(🔗) IP/DDNS/SN

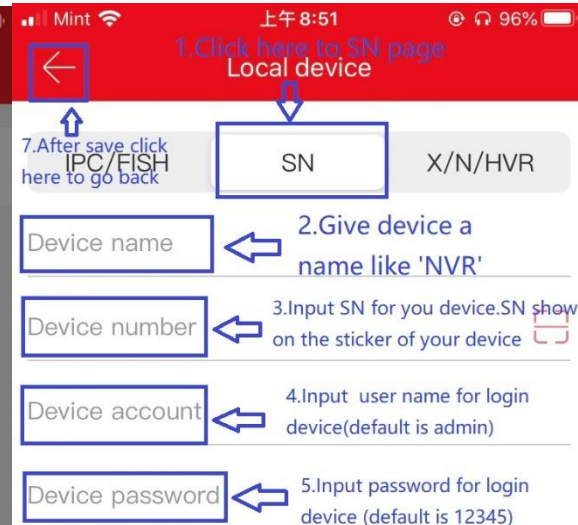

7. After save click here to go back



X/N/HVR

Device name



2. Give device a name like 'NVR'

Device number



3. Input SN for you device. SN show on the sticker of your device

Device account



4. Input user name for login device (default is admin)

Device password



5. Input password for login device (default is 12345)

6. After input information click save to add device

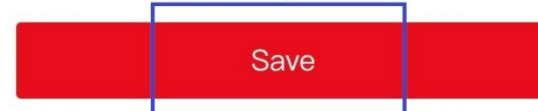

Save

